

PARTS LIST

- a. Hardware: will vary per project
- b. Strap: 3' length as standard
- c. Leaf: quantity and sizes will vary per project

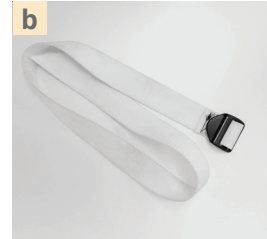
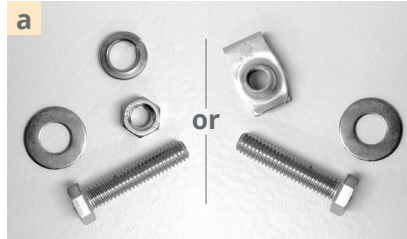

1 Organize Work Site and Ensure a Safe Work Environment

- a. Read all instructions and review all supplied drawings & packing list prior to starting any work.
- b. The following guide assumes that pole & antennas have been previously installed.
- c. Call Raycap if any parts are missing (part quantities will vary per project).
- d. Ensure that work is performed in fair weather conditions. Installation or removal of concealment radomes is NOT recommended in windy conditions.
- e. Use all industry established safety practices.
- f. Bolt radome pieces to steel structure per details in provided drawings.

2 Strap Attachment

- a. From left to right, weave straps through rectangular holes of the two adjacent leaves.

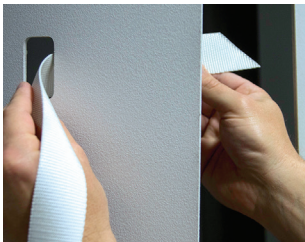

- b. To tighten, position buckle next to radome opening and pull strap such that you can still rotate it.

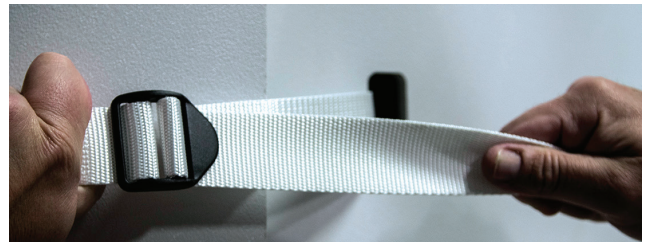

2 Strap Attachment (continued)

- c. Tuck the buckle just inside the left rectangular opening until the buckle is approximately 2" from the edge of the hole and pull the strap tight.

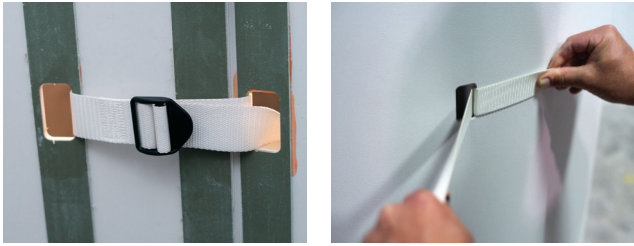
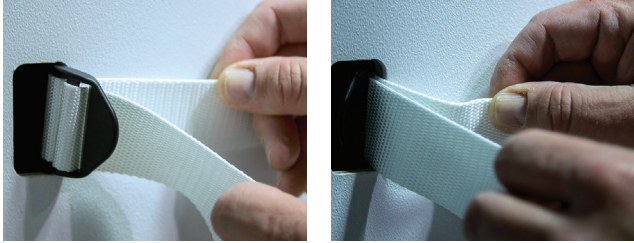

- d. To complete installation, tuck strap into rectangular hole on your left.

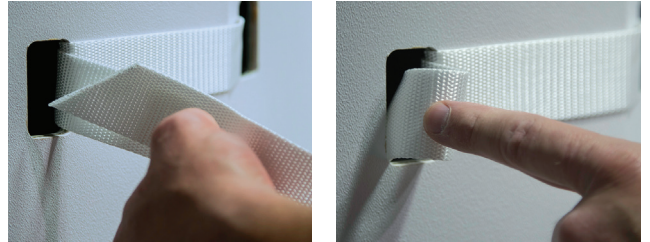

- e. Once tightened, your fingers will not fit between the strap and radome.

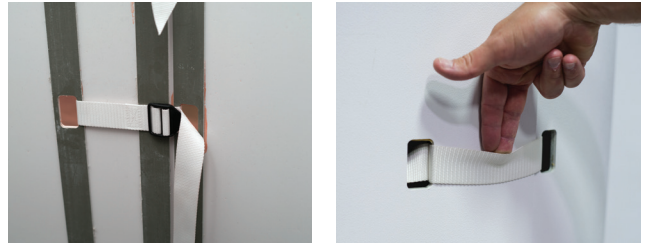

3 Radome Removal

- a. To open radome, reach into the hole and retrieve the end of the strap.

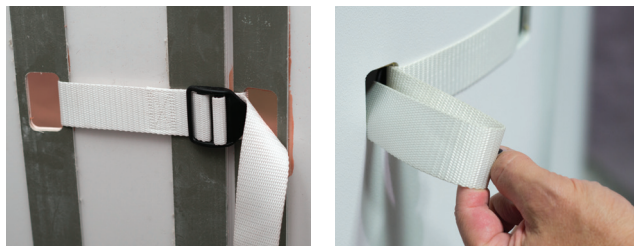

- b. Find the buckle, and push to loosen.

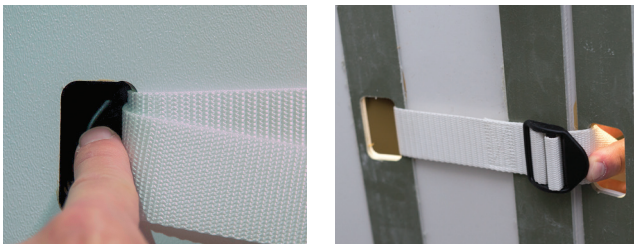

- c. Pull the buckle outside the slot.

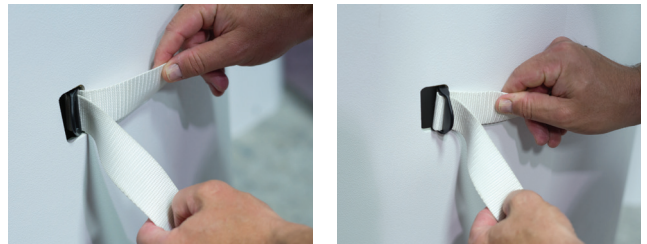

- d. Release buckle and remove.

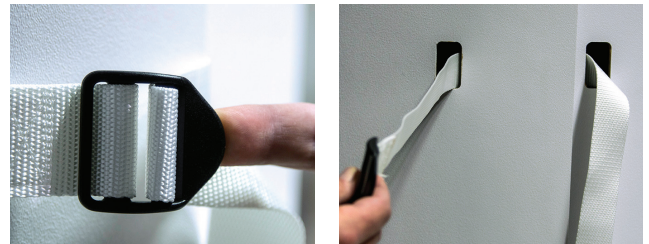

- e. Once all straps are removed on one side of the radome, the radome will remain in position.

NOTE: Accessing antennas or equipment inside the radome may be accomplished by removing straps on one leaf only.